



NORTHWEST YACHTS



Island Gypsy 39 Euro Sedan

Make:	Island Gypsy	Hull Material:	Fiberglass
Model:	39 Euro Sedan	Draft:	3 ft 11 in
Length:	39 ft	Number of Engines:	1
Year:	2012	Fuel Type:	Diesel
Condition:	New	Number:	557545
Location:	FOB Factory, China		

Description

Island Gypsy has a renewed and uncompromising focus on elevated quality standards and engineering excellence. Learning from the past and committed to today's technological advancements Island Gypsy is reintroducing the popular line - completely updated and redesigned. Safer, more comfortable, and better equipped than ever before.

The Euro Sedan 39 is certainly one of the best looking Island Gypsy's to date, exhibiting a perfectly balanced profile, layout and interior features. Island Gypsy's famous Burmese teak interior along with solid teak and holly soles make this a warm and inviting interior.

Northwest Yachts

Skyline Marina, 6060 Sands Way, Suite F, Anacortes, WA 98221, USA
Toll-free: 866-492-3138 Tel: 360-299-0777 sales@northwestyachts.com
<http://www.yachtworld.com/nwyachts>

Available with single or twin engines, the ES39 will run at the speeds of 10-18 knots. Her hard chine bottom provides a stable and sea kindly platform for coastal cruising or dock side cocktail parties.

You won't find a better value anywhere. Call or write for more information.

Measurements

LOA:	43 ft 3 in	Fuel Tanks Capacity:	400 gal
LWL:	35 ft 9 in		
Beam:	13 ft 4 in	Fresh Water Tanks Capacity:	200 gal
Max Bridge Clearance:	19 ft 4 in		
Max Draft:	3 ft 11 in		

Propulsion

Number of Engines:	1
Primary Engines:	Inboard
Drive Type:	Direct Drive
Engine Make:	Cummins
Engine Model:	QSB5.9

Dimensions

Displacement: 33,068 lbs

Engines

Total Power: 330
Cruising Speed: 10

Structure

- Hand laid G.R.P. solid skin bottom and superstructure; ASHLAND brand gelcoat; N.P.G. Isothalic
- Bottom skin laminates with vinylester resin. Minimum three layers of vinylester coated plies.
- Longitudinal stringers & transverse frame system, shaped using closed cell foam and encapsulated with e-glass
- 4 watertight compartments (chain locker, accommodation, engine room, and lazarette)

- The deck to hull seam is bolted, sealed with bonding adhesive and fiberglass bonding angles are applied to the inner seam

Standard Engine System

- Single CUMMINS QSB5.9-330 electronic diesel engine equipped with heat exchanger for fresh water cooling and ZF 80A transmission set
- Complete engine instrumentation at control station including engine overheat & low oil pressure alarm
- GRP drip pan under main engine
- Propeller shaft; stainless steel AQUAMET or equal, 2" (50.8mm) diameter with "P" bracket; turning inside two cutlass bearings
- P.Y.I. drip-less stern gland for engine shaft 2" (50.8mm)
- 4 blade propeller with double lock nut and stainless steel split pin system
- Engine room 12V D.C. - 4" blowers & natural air intake vents (2 each)
- Engine room sound proofing material with perforated aluminum fascia and hatch seals, SOUNDOWN brand or equal
- Hydralift wet box muffler with built-in drain cock
- RULE 12V D.C. 1500GPH electric bilge pumps with switches and auto/manual switching at electrical panel (3) with alarm and lights
- Manual bilge pump with three suction points (located under steps to forward area); Strum boxes in stainless steel

Steering and Trim Systems

- Rudder; molded fiberglass blade / stainless steel shaft
- HYDRIVE brand Hydraulic steering system with reservoir
- BENNETT brand trim tabs are mounted on each side of the transom with controls at the helm station

Fuel & Fresh Water Systems

- Aluminum fuel tankage (200 gal each) with hand hole clean out ports, shut off valve & sight gauges (2)
- Fuel management system including by-pass and dedicated fuel shut-off valves (ball valves only)
- RACOR fuel filter for main engine (Model FG900 single)
- GROCO ARG series bronze basket type internal sea water strainer for main engine
- Sea cocks on all through hull fittings with double hose clamped

- Water tankage 316 grade welded stainless steel with sight gauge, breather and hand hole clean out ports
- RARITAN 12 gallon (45.4 litre) 120V or 240V dual heating hot water heater tank system
- JABSCO brand 12V D.C. electric pressurized fresh water pump - 3.5 GPH flow rate with accumulation tank

AC Electrical System

- ONAN generator set. 5KW 120V AC or 4KW 240V AC including sound shield, muffler and remote start stop panel, includes dedicated 120 amp/hr start battery and fuel filter.
- Ship to shore 30 amp 120V AC or 32 amp 240V AC dock side inlet fitting (in cockpit).
- NEWMAR PT Series or similar 120V A.C. or 240 V A.C multistage 3 bank auto battery charger unit located at forward bulkhead in engine room. Includes built-in amp meter and dedicated circuit breaker at switch panel.
- NEWMAR integrated galvanic isolator.
- 120V A.C. or 240V A.C. electrical outlets to salon, galley, master cabin head, guest cabin & engine room with a built-in GFI system
- Electrical panel in 12V D.C. and 120V A.C. or 240 V A.C fitted with volt and amp meter, independent electric bilge pump auto/manual switching with alarms and warning lights, reverse polarity indicate light, circuit breakers with back lighting & battery bank indicator meter, all located behind a framed clear plexiglass door
- Wiring color coded & numbered to match regional color codes Australian, U.S. or Europe
- Copper bonding strap with ground cable attachment for each thru hull fitting

DC Electrical System

- Three heavy duty 200 amp hour 12V batteries in GRP boxes with lids; one dedicated for engine start + two for house lighting and inverter (deep cycle)
- Battery cut off switching panel
- SIDE POWER 6HP 12V D.C. electric bow thruster unit with remote control panel at helm station, including one 200 amp hour battery with box
- MUIR ATLANTIC 1200 12V D.C. 1265 lbs electric rope / chain windlass with up/down switches at helm station and fore deck, including fuse and standard accessories
- SONY or equal CD stereo speakers in salon with wiring to T.V. console cabinet (2)

- 12V D.C. double arm wipers to port, middle and starboard front windscreens with fresh water wash down system
- Horn 12V D.C. (electric)- mounted on main cabin roof. Switch located at main helm
- 12V D.C. accommodation ceiling lights throughout, recessed into headlining
- Engine hour, volt and water temperature meter at helm station Key start in CUMMINS panel set including back lighting

Hardware

- An integrated GRP anchor platform with stainless steel anchor roller assembly
- Bow & stern flag staffs in varnished teak with stainless base and lock nut
- Cleat 12" Heavy Duty type - 2 bow, 2 amidships, 4 aft in stainless steel with chocks (including transom chocks)
- Upper and lower stainless steel "D" section rub rails to hull port and starboard
- Deck rails - 1 1/4" stainless steel tubing in 316
- Windows are aluminum framed clear glass with insect screens. Selected windows slide
- Cabin door locks in stainless steel
- International navigation lights
- Six opening portholes with screens
- Aluminum mast head & running light post assembly mounted on cabin top (Hinging)

Salon

- Helm station with 24" teak spoked steering wheel and rim
- Fixed helm seat
- Chart locker
- Overhead electronics locker above steering station, with access hatch under
- Built in settee to port complete with cushion set, storage under with fiddles. Dedicated space set aside for seating starboard side in saloon, with two movable chairs
- Hi-lo teak dinette table. Folds down to form occasional double bed
- Bar with bottle and glass storage cabinet at Starboard side
- TV cabinet
- Teak & holly sole
- Overhead teak grab rail
- All furniture & bulkheads are golden Burmese teak in satin finish

- Head lining vinyl panels
- Daily hatch access to engine room with ladder & gas stay. All hatches removable
- Door lock with key on hinging door for access to salon. Door unit in stainless steel

Galley

- Teak galley unit with CORIAN or equal brand counter top & back splash
- SEAWARD brand or equivalent counter top type 3 burner gas stove unit; includes built-in oven unit below and alarm monitor panel set
- Stainless steel sink with cover & single lever swivel type faucet
- ISOTHERM flush-mount series under counter 12V D.C. / 120V or 240V A.C. refrigerator / freezer unit
- Cabinet with shelves under counter
- Overhead dish and cup locker
- 12V D.C. 4" electric exhaust fan above stove with stainless steel fascia plate
- Trash bin with lid including external access door

Master Stateroom

- Spacious Island berth arrangement with drawers under; includes mattress 5" (127mm) with cotton cover
- Built in teak wardrobes with internal cedar lining.
- Wardrobes with auto lights and door locks
- Head lining and hull side lower area in white vinyl panels
- Teak & holly sole
- Teak wood bulkheads with teak furniture
- Reading lamps brass swivel type 12V D.C. with individual switches (2)
- Escape hatch with built in insect screen located overhead
- 12V D.C. mood lighting under master berth

OPTIONAL Guest Cabin

- Upper & lower berth arrangement with 5" (127mm) foam mattress (2) drawers under
- Wardrobe with hinged door and internal light
- Side table
- Teak bulkheads with teak furniture
- Reading lamps brass swivel type 12V D.C. with individual switches (2)

- Head liner vinyl panels
- Teak and holly sole

Head - Shower

- Vanity unit fitted with integrated CORIAN or other brand wash basin, counter top with splash back and single lever faucet
- Single lever shower & sink hot and cold fresh water faucets
- Mirror with light
- JABSCO 12V D.C. electric macerator head with household size bowl
- 12V D.C. 4" JABSCO exhaust fan (2)
- Molded white gelcoat / FRP gloss finish head and shower lining & bulkheads
- 40 gal (151 litre) GRP holding tank with JABSCO Y-valve located in engine room with JABSCO macerator pump, deck discharge outlet & remote "Full" display panel in head
- Shower sole fiberglass base with automatic sump system, seat and removable teak grating panel.
- AC outlet mounted in head (GFI)
- Head & shower are separate in standard layout. Integrated in optional layout, but with a stall shower

Flybridge

- Helm station starboard side with built-in two person helm seat. This is a "back to back" seat for an additional 2 people to sit facing aft. A locker divides the 2 seats
- Vinyl cushion sets with tapered backing
- All seating with ample storage under
- "L" shaped lounge with table
- Storage in Flybridge brow
- 26" stainless steel destroyer type steering wheel
- Clear plexiglass windscreen with stainless steel grab rail
- 12V DC outlet for accessory mounted adjacent to helm station
- Aluminum mast 10'3" with boom 8'3" hinging above the s.s. rail. Mast to be stayed and capable of lifting 200kg
- Stainless steel safety rail (1"-25.4mm)
- Space for tender storage

Cockpit - Main Deck

- Non skid integrated pattern, white (same as deck gelcoat color) main decks
- Moulded steps to fly bridge from aft deck with non skid inlay and safety rail. Note: moulded steps built into storage locker assembly with 2 suspended steps above, plus the top step moulded into the fly bridge sole. Sliding hatch cover
- Transom door with step plates
- Flush access hatches to LAZARETTE and DRY LAZ areas
- Swim platform – 30" wide fiberglass with non-skid inlay and stainless steel “D” section rub rails
- Swim ladder, 4 step foldable type, made of stainless steel
- Telescoping from under the swim platform
- Transom shower - hot and cold fresh water

Dry Laz

- Dry storage between 2 W.T. bulkheads between E/R & lazarette. Sole surfaces are from the hull to maximize headroom. Engine bearers provide retaining spaces for storing gear/equipment
- Two overhead lights
- Ventilation via cockpit bulwarks
- Access via hinged gas stayed flush hatch

Lazarette

- Access from hinging deck hatch
- Contains rudder & steering gear.
- Wet gear storage
- Two overhead lights. (12V D.C.)

Miscellaneous

- Teak cap rails & trim. Minimum 5 coats of varnish
- Teak yacht name boards & hailing port boards
- Hull bottom anti-fouled paint
- Two cowl vents on Dorade boxes to trunk cabin
- Emergency tiller (single engine only)
- Zinc block affixed at transom

- All drawers drop down to lock type

Options

- Inverter charger in lieu of battery charger
- Generator - ONAN increased to 7kw
- CRUISAIR air-conditioner 10K in forward cabin
- CRUISAIR air-conditioner 18K in Salon
- Counter top type 2 burner electrical stove unit including microwave oven in lieu of SEAWARD gas stove unit including built-in oven unit
- Teak on bow deck
- Teak aft cockpit deck

History

If ever a yacht were to lay claim to a history of reliability, seaworthiness, exceptional value, and sheer owner satisfaction....it is Island Gypsy.

Originally created more than thirty years ago, it still epitomizes style, elegance and charm. Now, under the production direction of Vic Duppenhaler, Maxi Marine is constructing the traditional Island Gypsy but with many refinements....so today's Island Gypsy is safer, more comfortable and better equipped than ever before.

Disclaimer

The Company offers the details of this vessel in good faith. All items will be verified at time of signing contract. A buyer should instruct his agents, or his surveyors, to investigate such details as the buyer desires validated. This vessel is offered subject to prior sale, price change, or withdrawal without notice.

Photos



Photo 1



Bow



Bow 2



Helm



Salon



Stern

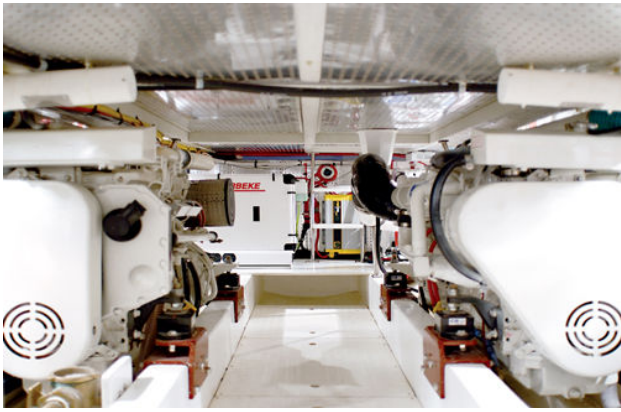

Engine Room (optional twin engines shown)



Galley



Stateroom



Salon Aft

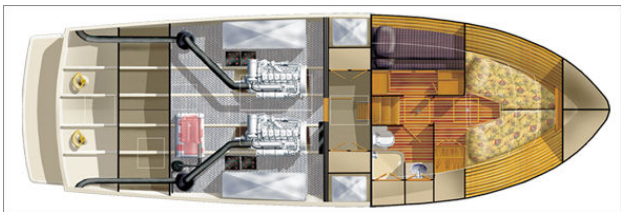

OPTIONAL Engine Room & 2nd Cabin Layout

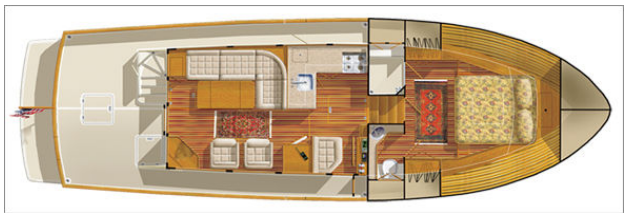

Standard Layout



Standard Flybridge



Steps to Flybridge